

CREATE A SIMPLE NECKLACE AS EASY AS 1-2-3

Materials :

- ± 90 cm of cotton waxed cord
- 1 pendant
- 1 jump ring - 6 mm
- 1 scissors
- 2 flat nose pliers
- 1 ruler
- Beadfix glue (optional)
- Sharp tool (optional)



1. Measure and cut ± 90 cm of 1,5 mm cotton waxed cord.



2. Using two flat nose pliers, twist open the jump ring.
Insert your open ring in the hole of the pendant and then close it up using again both flat nose pliers.



3. Insert one end of the cord in the ring and slide the pendant all the way to the center of your necklace.

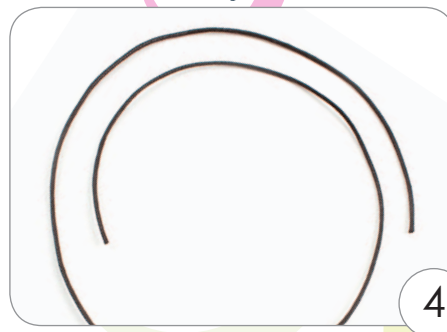

4. Form a circle with the cord, making sure to position both ends so that they overlap each other for a length of approximately 30 cm.



Online store

www.clubbeadplus.com
info@clubbeadplus.com

Customer service

☎ 514 904-0224 | 1 877 904-0224
📠 514 382-7156 | 1 888 382-7156

Store

185, rue De Louvain Ouest door 200
Montréal | Québec | H2N 1A3



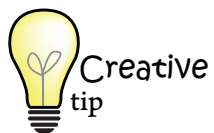

Creative
tip

CREATE A SIMPLE NECKLACE AS EASY AS 1-2-3

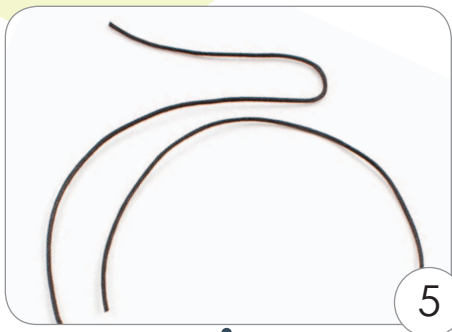

5. Measure about 10 cm starting from either one of the ends and fold the cord back over for again 10 cm.

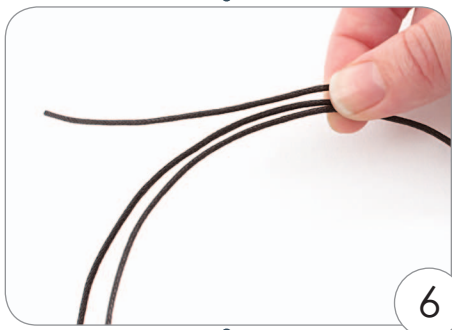

6. With your right hand, maintain the folded part on the cord, as illustrated.



7. With your left hand, take the shortest end of the cord and make a full circle around the two other cords.



8. Circle over both cords again and insert the end of your cord into the bow that was just made and also in the folded part you are holding in your right hand. Close up the knot, but not too tight so that it can move freely on the cord. Cut off any excess.



9. Repeat steps 5 to 8 with the other end in order to create the second knot.



10. If you wish to add glue on the knots, just apply a small amount of glue using a sharp tool. Caution: If glue is applied on the cord, in the center of the knot, it will make it impossible for the knot to move freely on the cord.



Online store

www.clubbeadplus.com
info@clubbeadplus.com

Customer service

☎ 514 904-0224 | 1 877 904-0224
📠 514 382-7156 | 1 888 382-7156

Store

185, rue De Louvain Ouest door 200
Montréal | Québec | H2N 1A3

